

**A**  
SIZE

PROJECTIONS

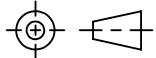

TOLERANCES UNLESS OTHERWISE SPECIFIED:

PLACES	INCHES	NOTES:
.XX	± .030	ACCEPTABLE BURR ± 10% OF MATERIAL THICKNESS
.XXX	± .015	ALL TOLERANCES ARE NON-CUMULATIVE
.XXX	± .005	ALL DIMENSIONS APPLY TO PART BEFORE ANY
ANGLE	± 3°	FINISH IS APPLIED

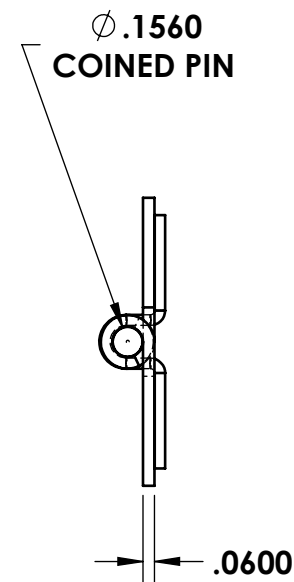
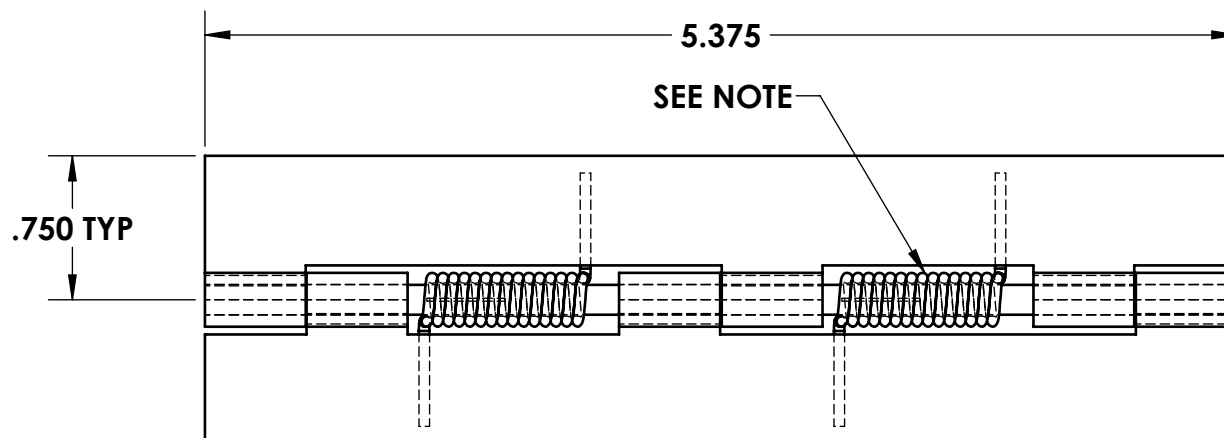

## NOTES:

1. FINISH: 361 - BRIGHT ANNEALED
2. SPRING: LOADED TO CLOSE, (2) PLACES, .055 WIRE DIA., .60 LEGS
3. KNUCKLES: .53 REF.

DWG #:

**NHSTS1127**

SCALE

1:1

CODE IDENT. #

DATE

06/05/2006

03007

B	COINED PIN WAS SPUN	10/14/2021	JG
A	CONVERTED, FINISH	09/26/2017	JG
REV.	DESCRIPTION	DATE	APPD

REVISIONS

MATERIAL:

304-ST5

FINISH:

SEE NOTE

DR. BY: RAG

CK. BY: CD

FAX: 1-631-737-2933

EMAIL: info@guden.com

WEB: www.guden.com

**GUDEN**  
INDUSTRIAL HARDWARE MADE EASY99 RAYNOR AVE.  
RONKONKOMA, N.Y. 11779  
1-800-3-HINGES