

**A**  
SIZE

PROJECTIONS

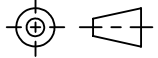

TOLERANCES UNLESS OTHERWISE SPECIFIED:

PLACES	INCHES	NOTES:
.XX	± .030	ACCEPTABLE BURR ± 10% OF MATERIAL THICKNESS
.XXX	± .015	ALL TOLERANCES ARE NON-CUMULATIVE
.XXXX	± .005	ALL DIMENSIONS APPLY TO PART BEFORE ANY FINISH IS APPLIED
ANGLE	± 3°	

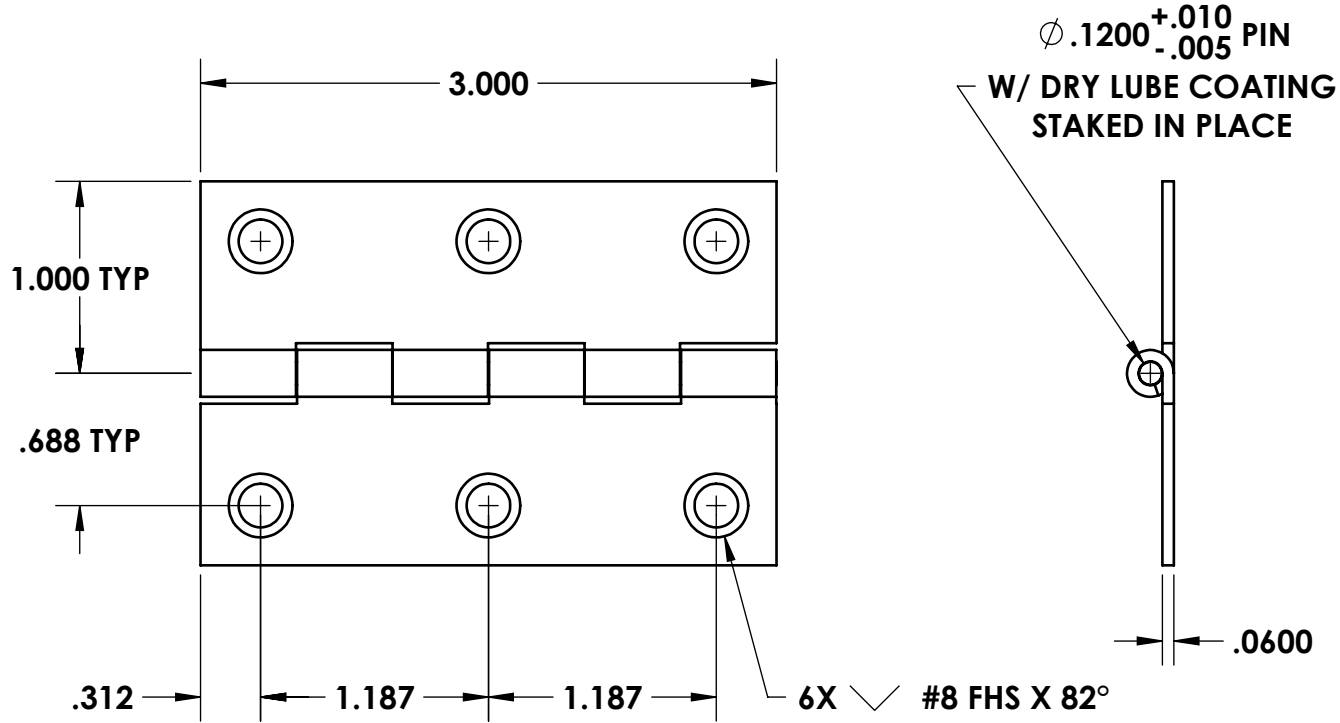

NOTES:  
1. FINISH: 21- ELECTRO POLISH

REV. DESCRIPTION DATE APPD				DWG #:	SCALE	1:1	CODE IDENT. #
C	ADDED PIN LUBE	01/08/2018	JG	<b>SP0993</b>	DATE	06/20/2001	03007
B	CONVERTED, VARIOUS CHANGES	05/05/2017	JG		MATERIAL: 304-ST5	FINISH: SEE NOTE	
A	CORRECTED # OF HOLES	12/23/2003	CD	DR. BY: RAG	CK. BY: CD		<b>GUDEN</b> INDUSTRIAL HARDWARE MADE EASY 99 RAYNOR AVE. RONKONKOMA, N.Y. 11779 1-800-3-HINGES
REV.	DESCRIPTION	DATE	APPD	FAX: 1-631-737-2933 EMAIL: info@guden.com WEB: www.guden.com			
REVISIONS							