

A
SIZE

PROJECTIONS

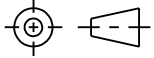

TOLERANCES UNLESS OTHERWISE SPECIFIED:

PLACES	INCHES	NOTES:
.XX	± .030	ACCEPTABLE BURR ± 10% OF MATERIAL THICKNESS
.XXX	± .015	ALL TOLERANCES ARE NON-CUMULATIVE
.XXXX	± .005	ALL DIMENSIONS APPLY TO PART BEFORE ANY FINISH IS APPLIED
ANGLE	± 3°	

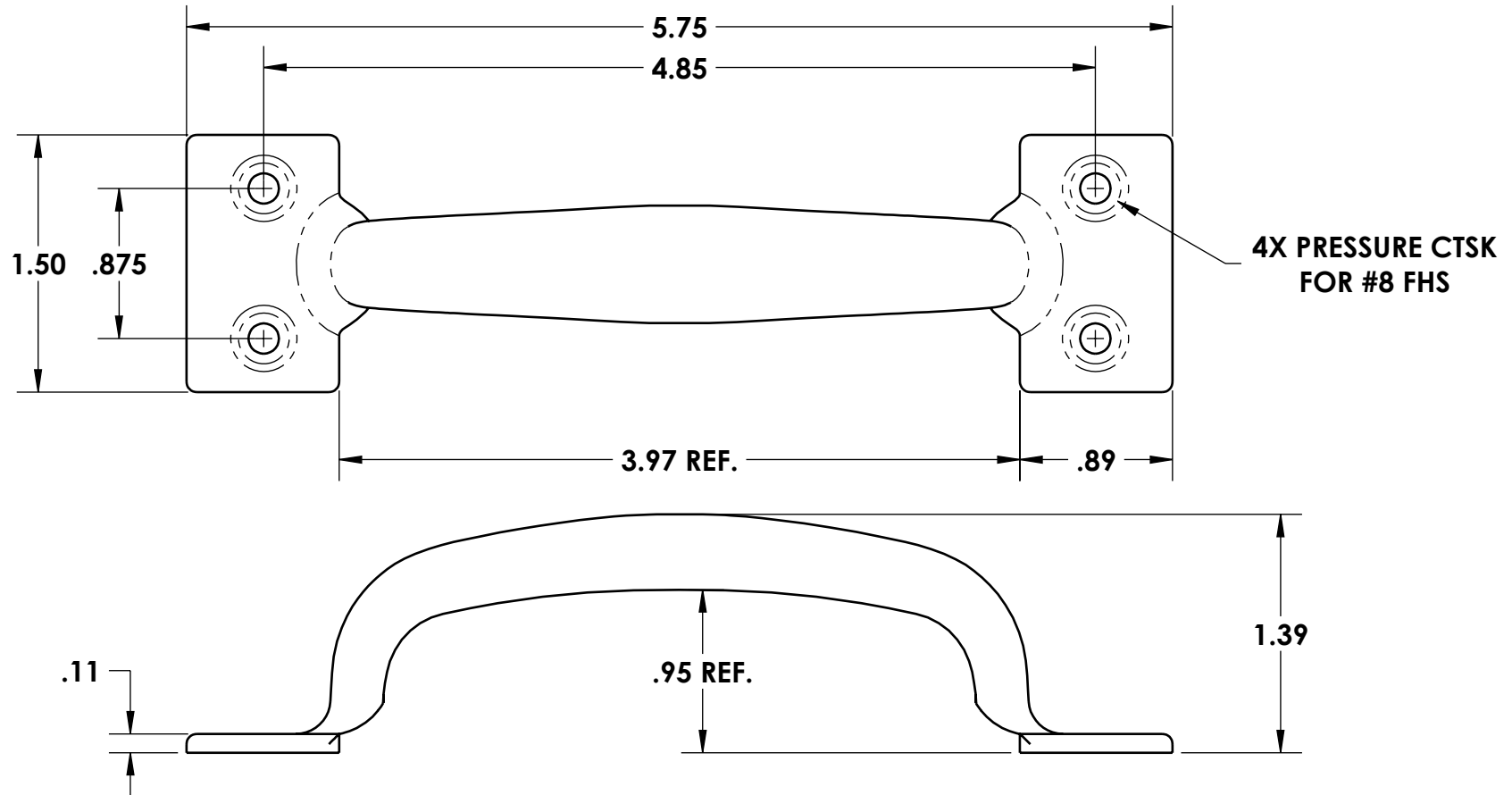

NOTES:

1. FINISH: 105- BARREL ZINC AND CLEAR TRIVALENT CHROMATE
2. HANDLE PACKED IN PLASTIC BAG WITH (4) #8 X 5/8" FHS (PHILLIPS)

E	3.97 REF., .95 REF. WAS 3.97, .95	02/01/2023	JG	DWG #: 482-2-02	SCALE	1:1	CODE IDENT. #
					DATE	07/01/1999	03007
D	CONVERTED	03/22/2018	JG	MATERIAL: PS	FINISH: SEE NOTE	 GUDEN INDUSTRIAL HARDWARE MADE EASY 99 RAYNOR AVE. RONKONKOMA, N.Y. 11779 1-800-3-HINGES	
C	VARIOUS CHANGES	06/20/2016	JG				
B	FINISH AND SCREWS	04/05/2016	JG	DR. BY: RAG	CK. BY: CD		
REV.	DESCRIPTION	DATE	APPD	FAX: 1-631-737-2933 EMAIL: info@guden.com WEB: www.guden.com			
REVISIONS							