

**A**  
SIZE

PROJECTIONS

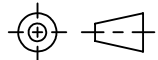

## TOLERANCES UNLESS OTHERWISE SPECIFIED:

| PLACES | INCHES | NOTES:  |
|--------|--------|---|
| .XX    | ± .030 | ACCEPTABLE BURR ± 10% OF MATERIAL THICKNESS               |
| .XXX   | ± .015 | ALL TOLERANCES ARE NON-CUMULATIVE                         |
| .XXXX  | ± .005 | ALL DIMENSIONS APPLY TO PART BEFORE ANY FINISH IS APPLIED |
| ANGLE  | ± 3°   |   |

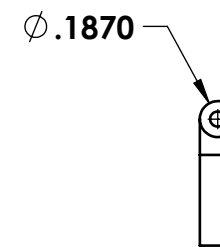
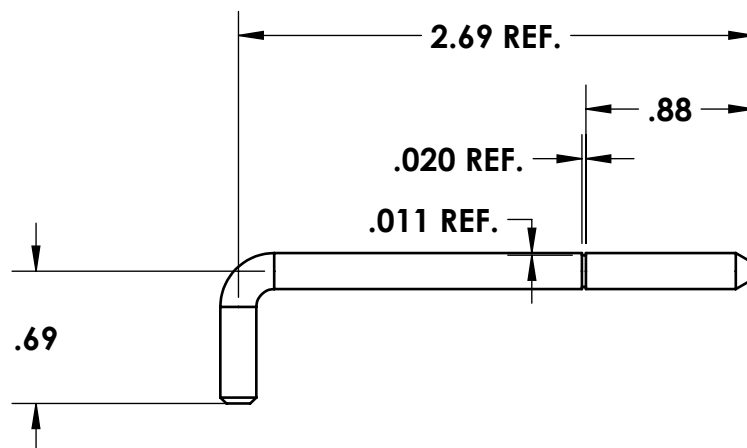

## NOTES:

1. FINISH: 00- NO FINISH

DWG #:

**9294-32PIN**

SCALE

1:1

CODE IDENT. #

DATE

02/10/2017

03007

MATERIAL:  
304-ST5FINISH:  
SEE NOTE

DR. BY: RAG

CK. BY: JPG

FAX: 1-631-737-2933  
EMAIL: info@guden.com  
WEB: www.guden.com

**GUDEN**  
INDUSTRIAL HARDWARE MADE EASY  
99 RAYNOR AVE.  
RONKONKOMA, N.Y. 11779  
1-800-3-HINGES

REV.

DESCRIPTION

DATE

APPD

REVISIONS