

**A**  
SIZE

PROJECTIONS

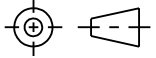

TOLERANCES UNLESS OTHERWISE SPECIFIED:

PLACES	INCHES	NOTES:
.XX	± .030	ACCEPTABLE BURR ± 10% OF MATERIAL THICKNESS
.XXX	± .015	ALL TOLERANCES ARE NON-CUMULATIVE
.XXXX	± .005	ALL DIMENSIONS APPLY TO PART BEFORE ANY FINISH IS APPLIED
ANGLE	± 3°	

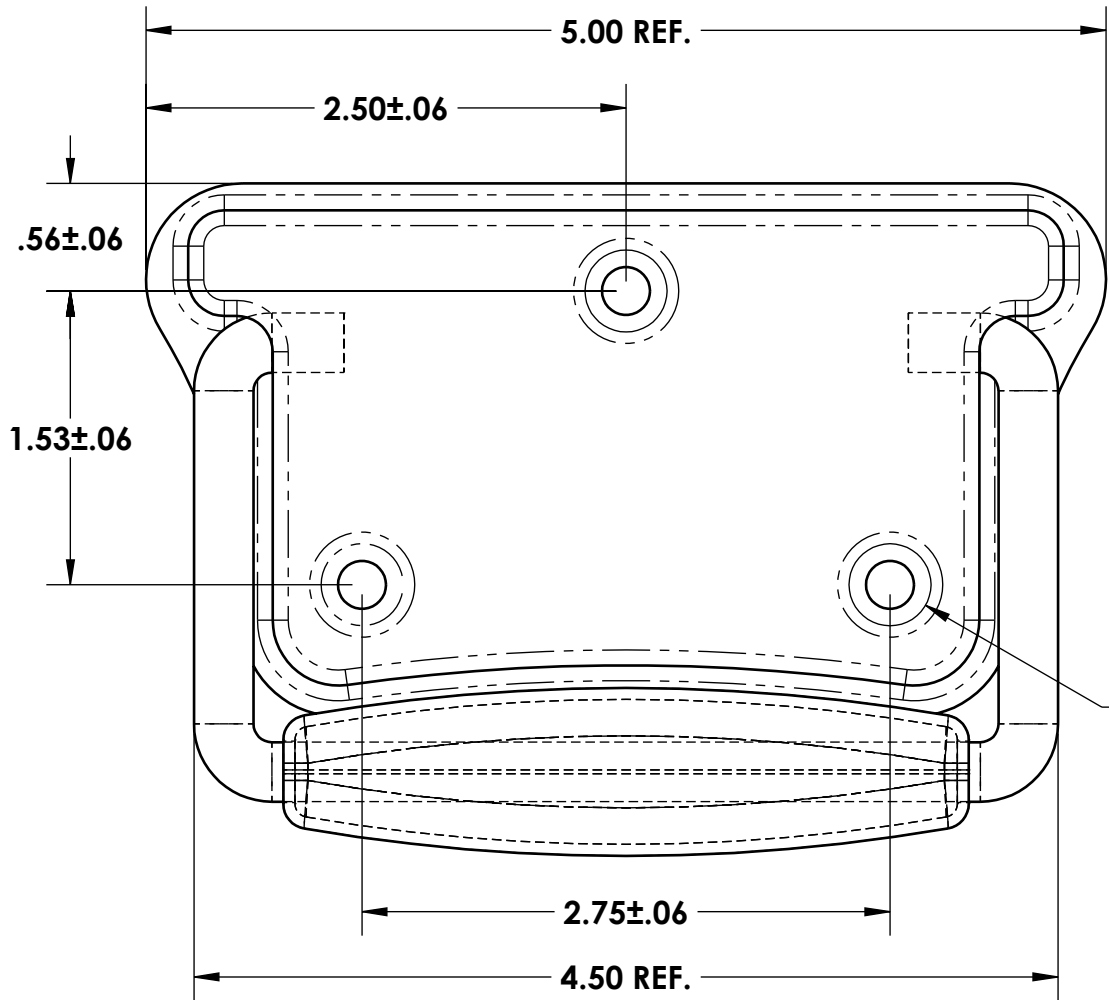

3X PRESSURE  
CTSK FOR #10 FHS

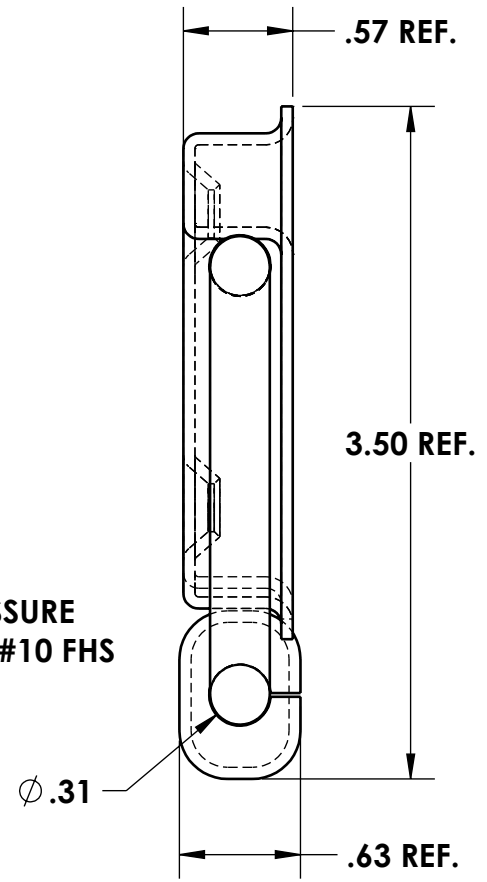

- NOTES:  
 1. FINISH: 40A COMMERCIAL TRIVALENT CHROMIUM  
 2. SPRING LOADED WITH 90° (REF.) STOP

REV.	DESCRIPTION	DATE	APPD
C	CHANGED FINISH	02/09/2023	JG
B	CONVERTED	03/05/2018	JG
A	CHANGED FINISH	07/06/2015	JG

REVISIONS

DWG #: <b>1209-26</b>	
MATERIAL: PS	FINISH: SEE NOTE
DR. BY: RAG	CK. BY: JPG
FAX: 1-631-737-2933 EMAIL: info@guden.com WEB: www.guden.com	

SCALE	1:1	CODE IDENT. #
DATE	09/15/2014	03007
 INDUSTRIAL HARDWARE MADE EASY 99 RAYNOR AVE. RONKONKOMA, N.Y. 11779 1-800-3-HINGES		