

**A**  
SIZE

PROJECTIONS

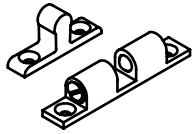
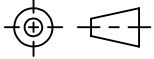

TOLERANCES UNLESS OTHERWISE SPECIFIED:

PLACES	INCHES	NOTES:
.XX	± .030	ACCEPTABLE BURR ± 10% OF MATERIAL THICKNESS
.XXX	± .015	ALL TOLERANCES ARE NON-CUMULATIVE
.XXXX	± .005	ALL DIMENSIONS APPLY TO PART BEFORE ANY FINISH IS APPLIED
ANGLE	± 3°	

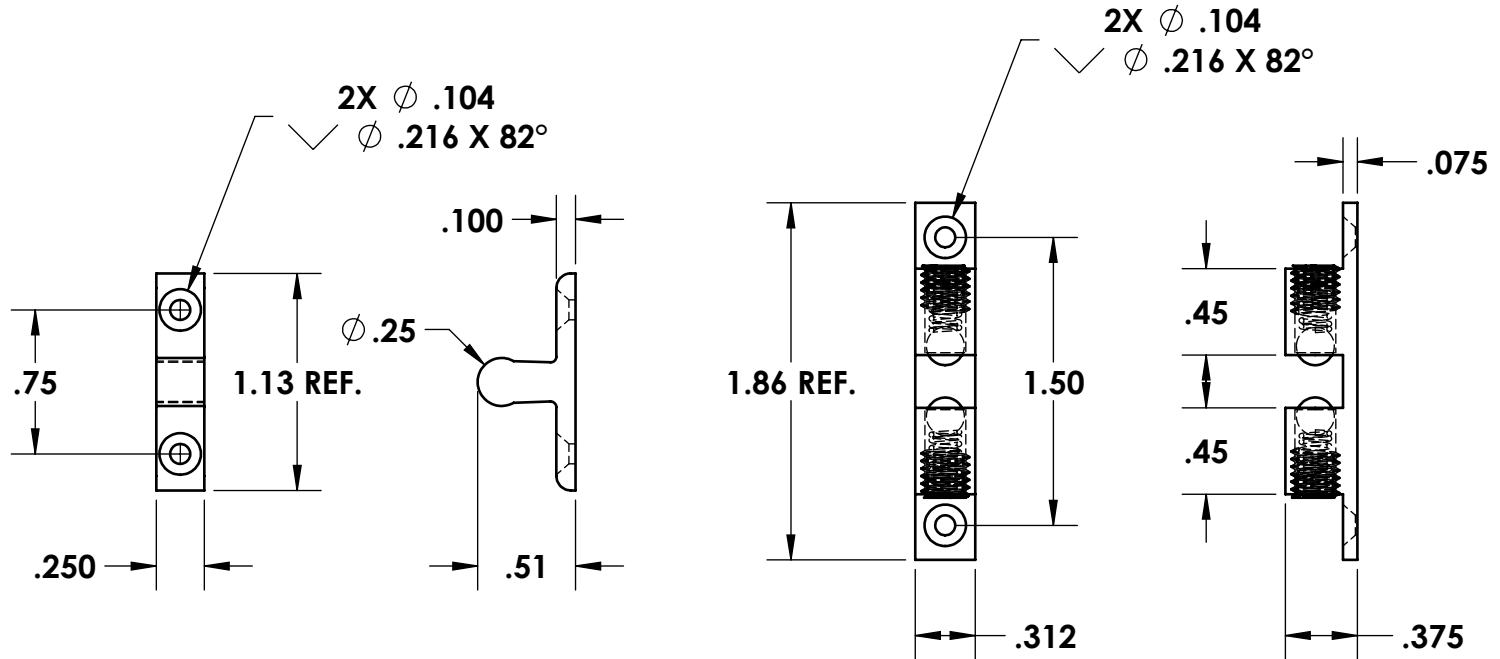

**NOTES:**

1. FINISH: 46A- BRUSHED CHROME
2. MATERIAL: BODY, STRIKE, BALL, AND ADJUSTER SCREW = BRASS  
SPRING = STS

				DWG #:		SCALE	1:1	CODE IDENT. #
				<b>1-26D</b>		DATE	04/16/1999	03007
G	CONVERTED, FINISH	07/17/2017	JG	MATERIAL:	FINISH:	 <b>GUDEN</b> INDUSTRIAL HARDWARE MADE EASY 99 RAYNOR AVE. RONKONKOMA, N.Y. 11779 1-800-3-HINGES		
F	BALL WAS BRONZE	03/10/2014	JG	SEE NOTE	SEE NOTE			
E	CHANGED FINISH	02/07/2002	CD	DR. BY: RAG	CK. BY: CD			
REV.	DESCRIPTION	DATE	APPD					
REVISIONS				FAX: 1-631-737-2933				
				EMAIL: info@guden.com				
				WEB: www.guden.com				