

**B**  
SIZE

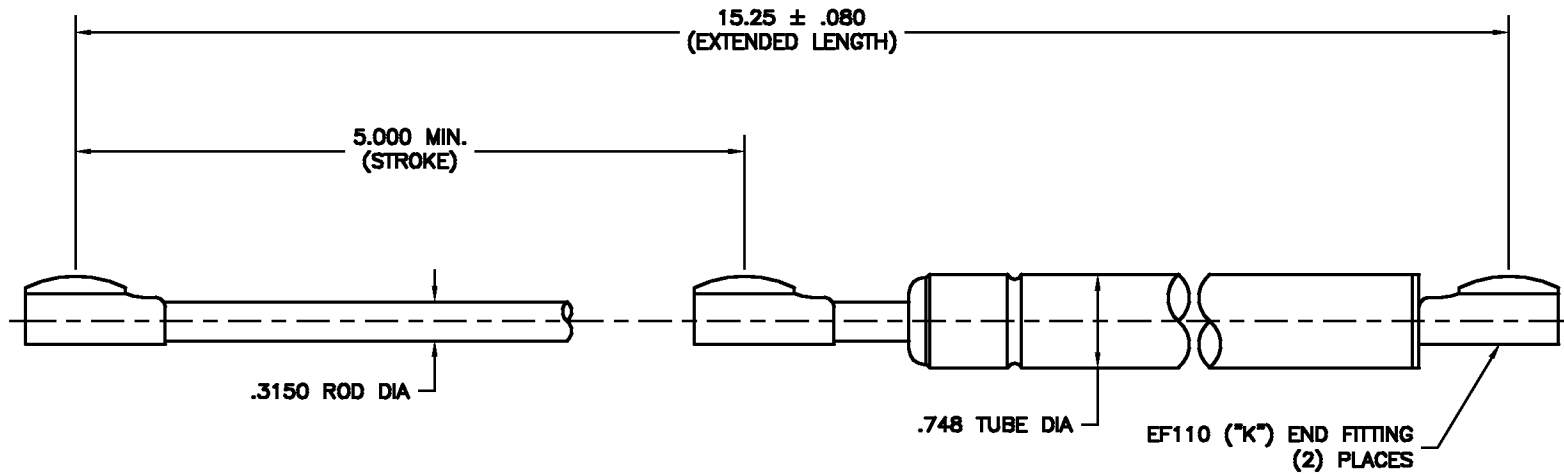

TOLERANCES UNLESS OTHERWISE SPECIFIED:		
PLACES	INCH	NOTE:
XX	± .030	ACCEPTABLE BURR ± 10% OF MATERIAL THICKNESS ALL DIMENSIONS APPLY TO PART BEFORE ANY FINISH IS APPLIED
XXX	± .015	
XXXX	± .005	
ANGLE	3°	



**NOTES:**

1. FINISH: 61- BLACK PAINT (TUBE) AND CHROME (ROD)
2. LABEL TO BE STAMPED WITH CORRESPONDING GUDEN P/N AND DATE CODE.  
(DATE CODE EX: 0568 IS THE 56th DAY OF 1998)
3. P1 FORCE = 90 lbs ± 7.0 lbs

DWG GG22-090-K		SCALE N/A	CODE IDENT. # 03007
MATERIAL PS	FINISH SEE NOTE		
DR. BY RAG	CK. BY CD		
FAX: 1-831-737-2933 EMAIL: info@guden.com WEB: www.guden.com		99 RAYNOR AVE. RONKONKOMA, N.Y. 11779 1-800-3-HINGES	

LTR	DESCRIPTION	DATE	APPD
	REVISION		